

SmartX AS-B Server

SmartX Server

Regulatory Compliance and Safety Information

Electrical equipment should be installed, operated, serviced, and maintained only by qualified personnel. No responsibility is assumed by Daikin for any consequences arising out of the use of this material.

Carefully read these instructions and all information relevant for this product before trying to install it. See the list of technical literature. The technical literature and declarations of conformity can be accessed on the Daikin website, drm.daikinmalaysia.com/download. Contact your local Daikin sales office for hard copy of documentation or for additional information.

Technical Literature

- SmartX Controller - Hardware Reference Guide, 04-XX001-XX-en

Dimensions

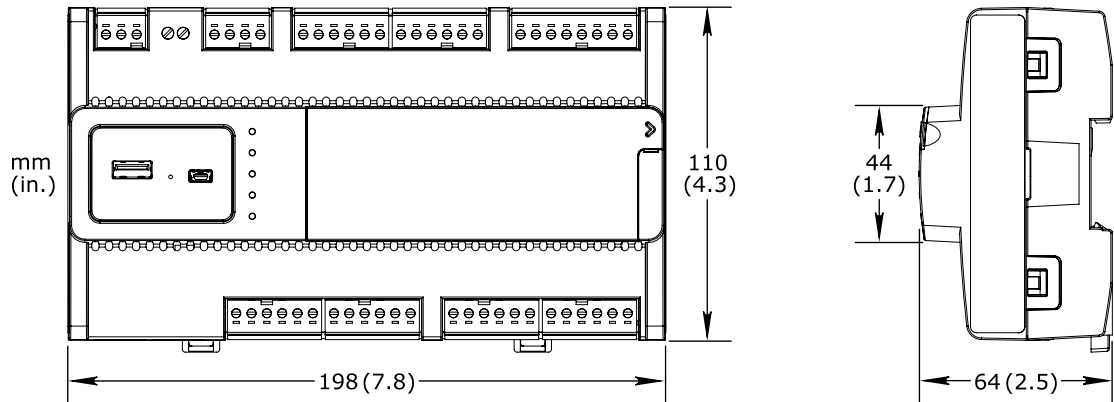

Installing the Device

Spare terminal blocks can be ordered using the part number SXWASBCON10001.

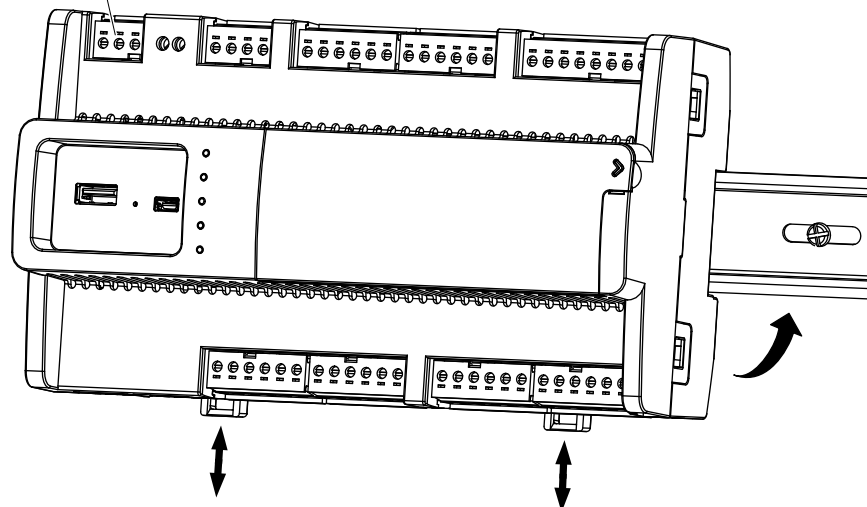

Warning: Install the device on a horizontal DIN rail. This position provides sufficient cooling air flow through the device. Installation on a vertical DIN rail can reduce the life span of the module.

Installing a Terminal Block

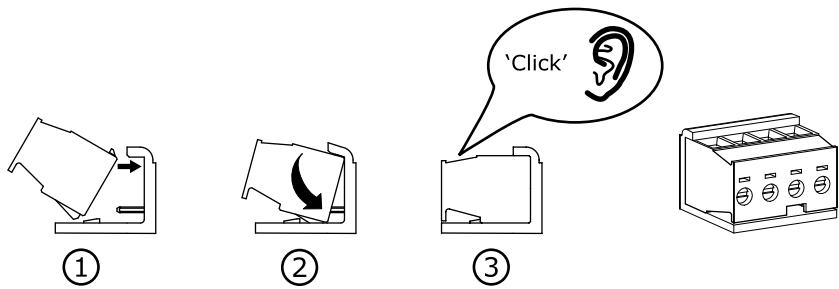

 **Caution:** Do not push the terminal block straight down into the connector header. This may cause the back wall of the header to crack.

 **Caution:** Use only terminal blocks delivered with the device or ordered from Schneider Electric using the part number SXWASBCON10001.

Removing a Terminal Block

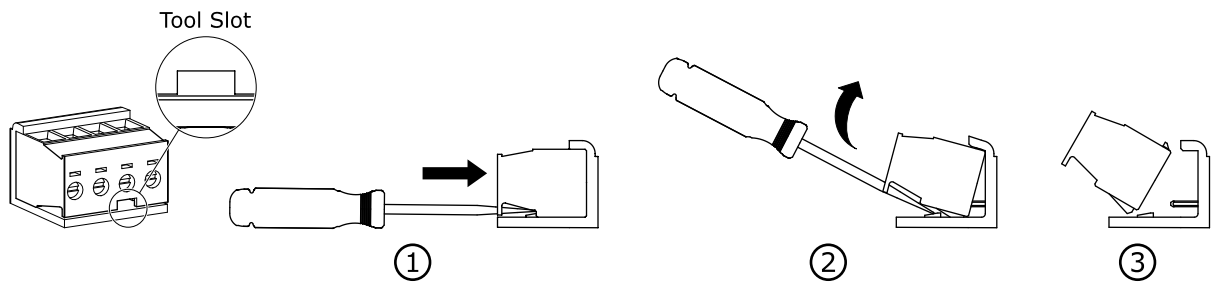

Labeling the Device

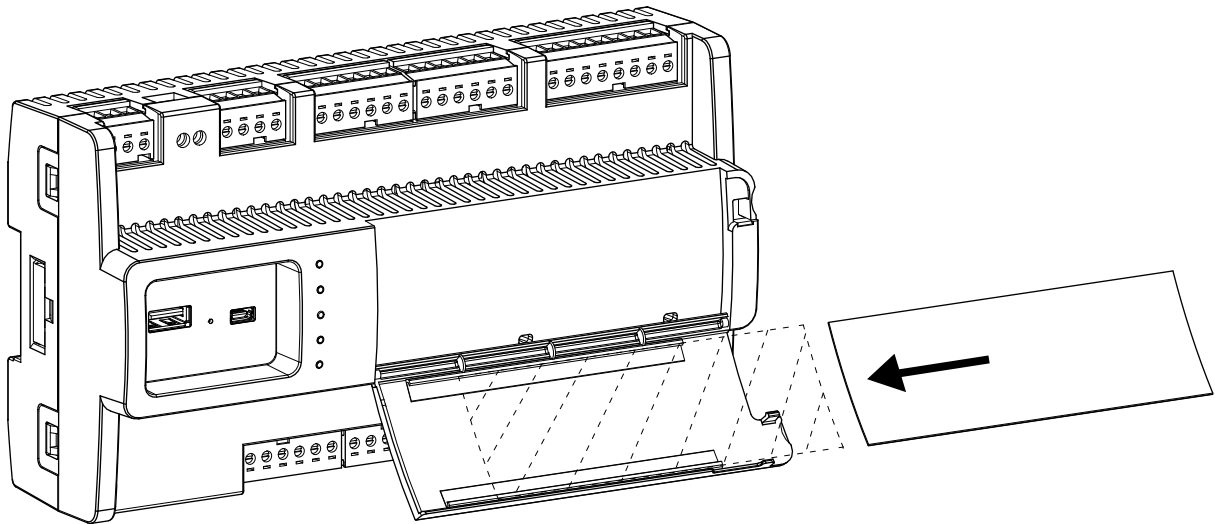

Connections



Warning: Properly ground the device and correctly wire the RS-485 network. Correct grounding and wiring is important for safety, performance, and reliability. For more information, see Hardware Reference Guide.



Warning: Ensure you install and wire the correct server model and plug the correct terminal block into the intended connector header. Incorrect wiring can cause damage to the electronics.

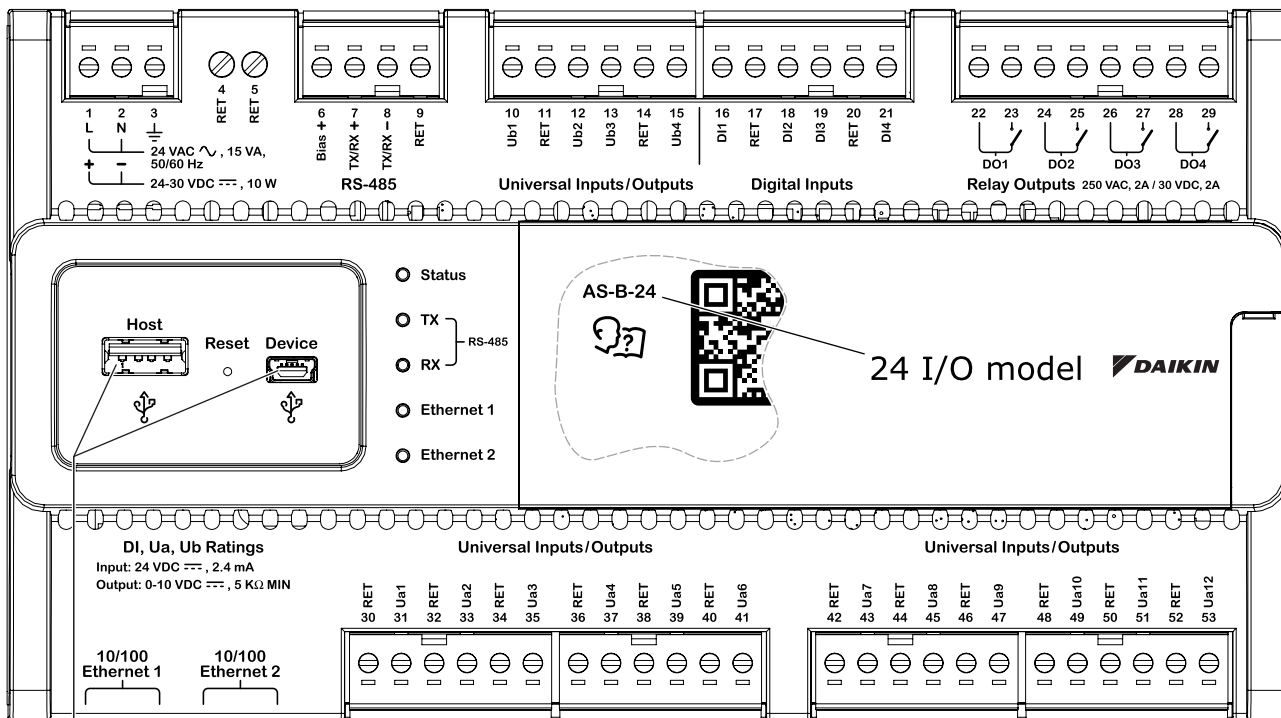

The connection cable for the USB ports must not exceed 3 m (10 ft).

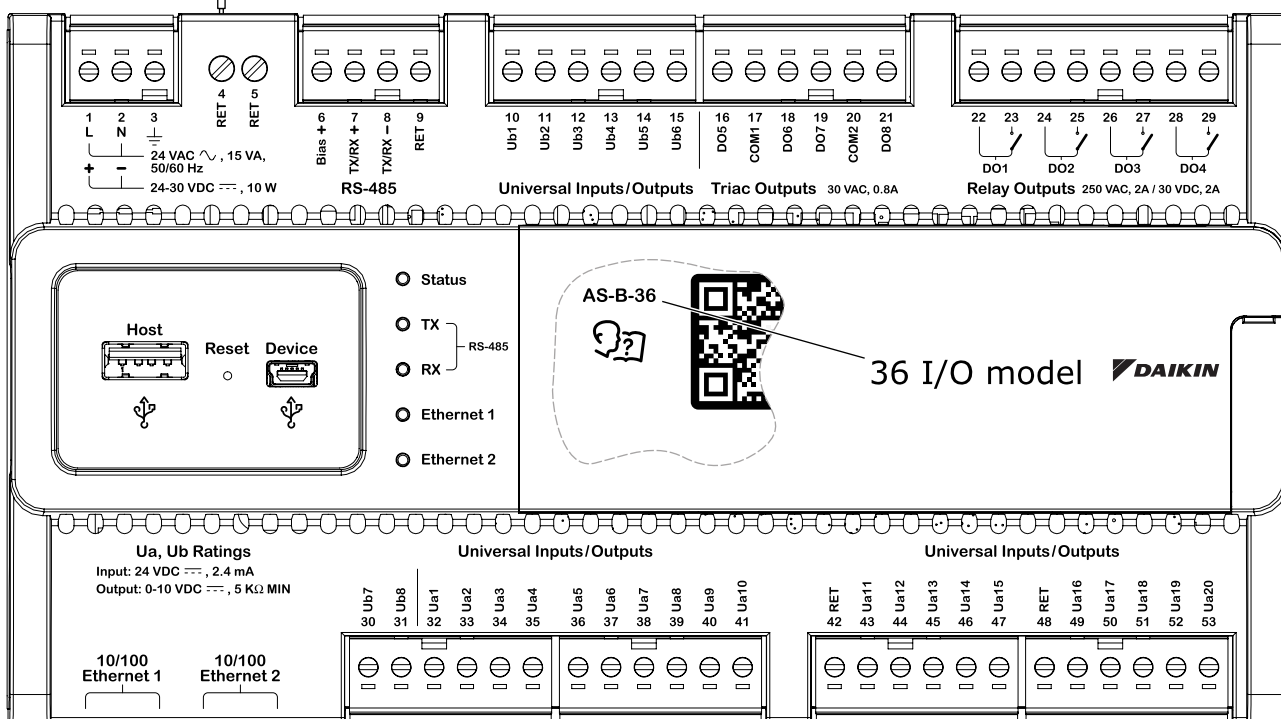
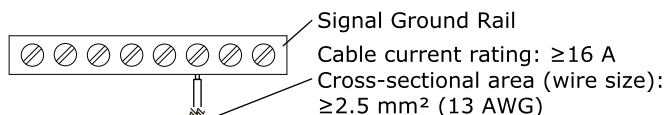

Part Numbers

Product	Part number
AS-B-24	DKN-SXWASB24X10001
AS-B-24H	DKN-SXWASB24H10001
AS-B-36	DKN-SXWASB36X10001
AS-B-36H	DKN-SXWASB36H10001
AS-B connector kit	SXWASBCON10001
AS-B installer kit	SXWASBINS10001

- SmartX AS-B servers with "H" in the product name are equipped with an override display.

Specifications

AC input Nominal voltage 24 VAC ~ 50/60 Hz Recommended transformer rating ≥ 15 VA DC input Nominal voltage 24 to 30 VDC --- Power consumption 10 W Port types USB device port Mini-B USB host port Type-A Ethernet port 1 and 2 10/100BASE-TX RJ45 Operation environment Ambient temperature, operating 0 to 50 °C (32 to 122 °F) Humidity Maximum 95 % RH non-condensing Mechanical Ingress protection rating IP 20	Plastic flame rating UL94-5VB Electrical Default (static) IP address 192.168.1.99 Regulatory compliance EMC, safety, and environment FCC CFR 47 Part 15 Class B, ICES-003 Class B, RCM, CE - EMCD 2014/30/EU, CE - LVD 2014/35/EU, WEEE 2012/19/EU, RoHS 2011/65/EU and 2015/863/EU, China RoHS SJ/T 11364-2014, UL 916 Listed products for the United States and Canada, Open Class Energy Management Equipment (UL file E80146.) Ua – Universal I/O Input rating 24 VDC ---, 2.4 mA Output rating 0 to 10 VDC ---, 5 kohm (min.) Channels 12 (Models with 24 I/O points) 20 (Models with 36 I/O points)	Ub – Universal I/O Input rating 24 VDC ---, 2.4 mA Output rating 0 to 10 VDC ---, 5 kohm (min.) Channels 4 (Models with 24 I/O points) 8 (Models with 36 I/O points) DO – Relay outputs Relay contact rating 250 VAC ~ / 30 VDC ---, 2 A Pilot Duty (C300) Channels 4 DO – Triac outputs Triac rating Max. 30 VAC ~, 0.8 A Channels 4 (Models with 36 I/O points) DI – Digital inputs Input rating 24 VDC ---, 2.4 mA Channels 4 (Models with 24 I/O points)
---	--	--

Addendum - California Proposition 65 Warning Statement for California Residents

⚠ WARNING: This product can expose you to chemicals including lead which is known to the State of California to cause cancer and which is known to the State of California to cause birth defects or other reproductive harm. For more information go to www.P65Warnings.ca.gov

部件名称 (Part Name)	有害物质 (Hazardous Substances)					
	铅 (Pb)	汞 (Hg)	镉 (Cd)	六价铬 (Cr (VI))	多溴联苯 (PBB)	多溴二苯醚 (PBDE)
塑料部件 (Plastic Parts)	○	○	○	○	○	○
电子件 (Electronics)	X	○	○	○	○	○

本表格依据 SJ/T11364 的规定编制。(This table is made according to SJ/T 11364.)

○: 表示该有害物质在该部件所有均质材料中的含量均在 GB/T 26572 规定的限量要求以下。
 (Indicates that the concentration of hazardous substance in all of the homogeneous materials for this part is below the limit as stipulated in GB/T 26572.)

X: 表示该有害物质至少在该部件的某一均质材料中的含量超出 GB/T 26572 规定的限量要求。
 (Indicates that the concentration of hazardous substance in at least one of the homogeneous materials used for this part is above the limit as stipulated in GB/T 26572.)



Wiring

For information on wiring, see the SmartX Controller - Hardware Reference Guide.

SmartX AS-B Server Software

The SmartX AS-B server is delivered without software. Install the software on the SmartX AS-B server using Device Administrator.

Software License Notice

This product contains code that is covered by the GNU General Public License (GPL). The relevant code is available at The Exchange Extranet, <https://ecobuilding.schneider-electric.com>